



Fantini

WiFi PROGRAMMABLE THERMOSTATS WHENEVER WHEREVER CONNECTED



SEMI-FLUSH MOUNTING



WALL MOUNTING

IntelliClima +



WHENEVER WHEREVER CONNECTED

Intellitouch CH193WiFi and Intellicomfort CH180WiFi are the new programmable thermostats that controls heating and cooling systems via a WiFi connection, which can be programmed and controlled directly or through the APP on a smartphone and tablet.

CONSUMPTION MINIMIZED

With the Intelliclima+ APP you can activate or switch off the heating system at any time and wherever you may be, avoiding unnecessary waste of energy.

IDEAL TEMPERATURE

You can always choose the ideal temperature and until when to set it. With Intelliclima+ you can change the temperature or the hourly programming to have always ideal comfort level, even when you are away from home.

SHARE WITH WHOEVER YOU WANT

With Intelliclima+ APP you can share the programmable thermostat management with the users you want.

ONLINE USER ASSISTANCE

If you need assistance, a technician can connect directly to your system and intervene quickly.



Intellitouch WiFi Intellicomfort WiFi

Fantini Cosmi presents Intellitouch and Intellicomfort WiFi, the new touchscreen programmable thermostats with weekly programming and WiFi connection for direct control or via the APP. With Intelliclima+ you're always connected to your Fantini Cosmi programmable thermostats and you are able to manage your ideal comfort levels in a simple and intuitive way, from a smartphone or tablet, wherever you may be.



A COMFORT CUSTOM MADE



Francesca is a nurse and works on shifts. It's really complicated for her to program the home programmable thermostat, as the times are never the same from week to week. If she forgets to reprogram the thermostat, she may find the home cold when she returns after work or the heating may be on when it is not needed. Everything's easier since she started using the new Intellilima+ APP. She simply increases the home temperature from her smartphone just before finishing her shift to find a warm and comfortable environment upon her return, avoiding unnecessary energy waste.

Francesca

Nurse



Edoardo

Entrepreneur

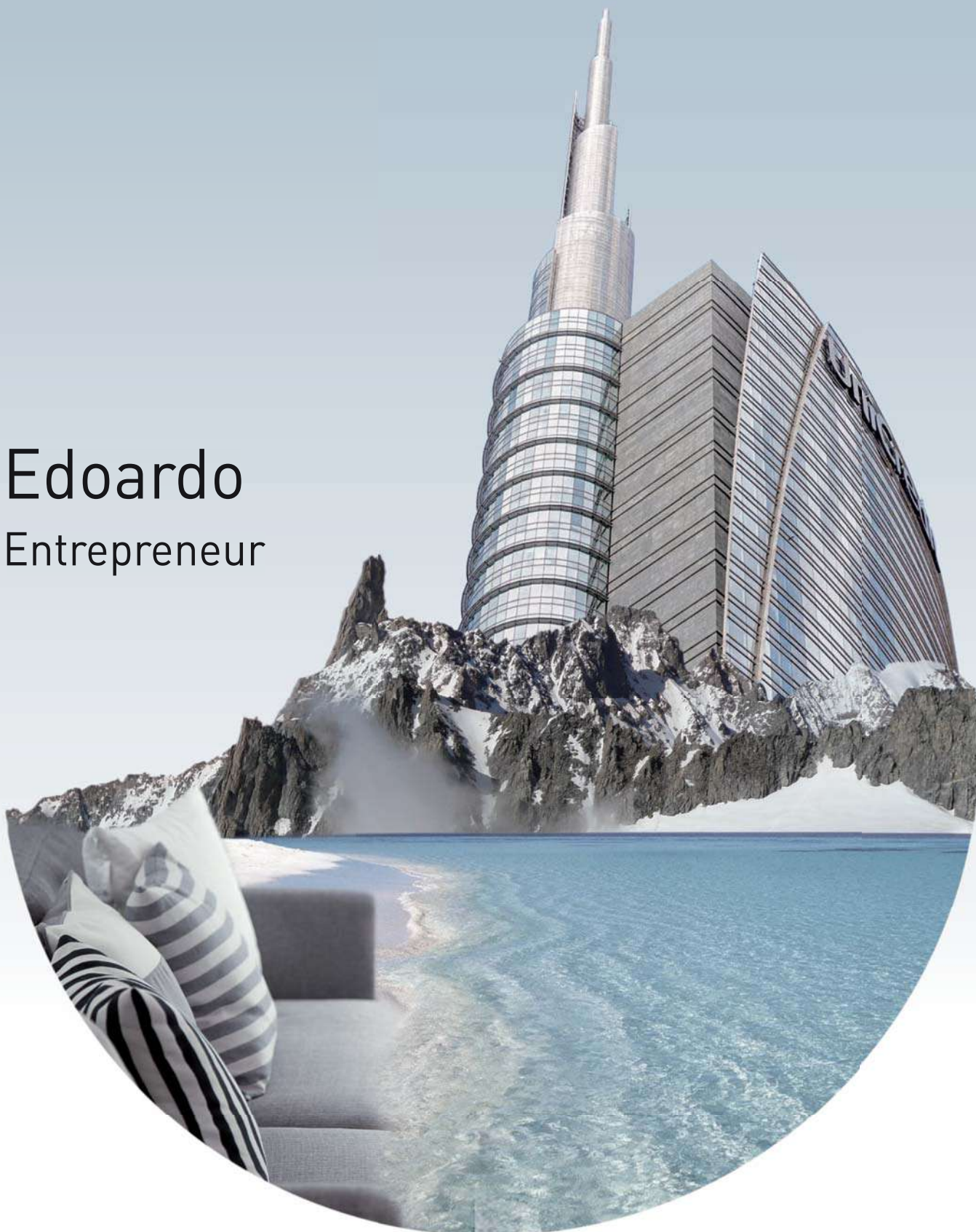



Milan home



Mountain home



Beach home



Edoardo is a Milanese entrepreneur, whose work and hectic rhythms absorb his energy, but when the weekend arrives, the beach or mountain home welcomes him for two days of relax. Thanks to the Intellliclima+ APP he can turn on the heating system directly from his tablet and upon his arrival, find the mountain home already warm. Schedule change? No problem, wherever he is and at any time he can control the temperature in the beach home or monitor that one in Milan and receive notifications in the event of any anomaly.

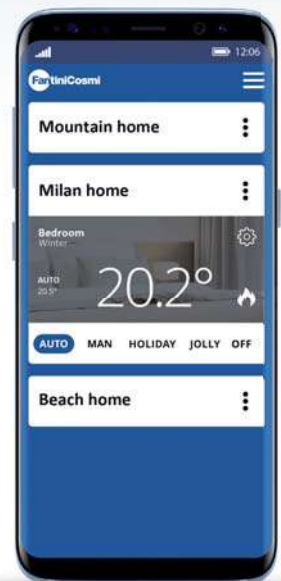



Alessandro has a design studio and is renovating a home for a new client, who wants to have two different temperatures in the sleeping area and living area. Alessandro finds the right solution for his client's needs in Intellitouch and the Intelliclimate+ APP. Indeed, by installing one programmable thermostat for the living area and one for the sleeping area he will achieve utmost comfort and with the Intelliclimate+ APP he will be able to control them both, always choosing the right temperature for each environment, wherever he may be.

Alessandro

Designer



THE WiFi PROGRAMMABLE THERMOSTATS

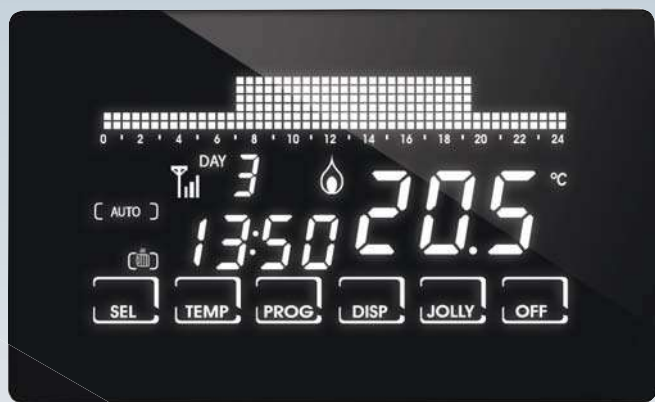

Intellitouch WiFi

Semi-flush mounting weekly programmable thermostat with WiFi connection

Design, technology and elegance are the keywords for the new range of Intellitouch WiFi programmable thermostats with an ultra-slim profile, touch screen glass screen and white backlight on a black background.

The total flat design and the choice of a black or white frame make Intellitouch WiFi a modern and stylish complement.

The Intellitouch WiFi series has weekly programming to control heating and cooling systems via a WiFi connection, directly or via the Intelliclimate+ APP on a smartphone or tablet.

With Intelliclimate+ your CH193WiFi programmable thermostat is always connected!



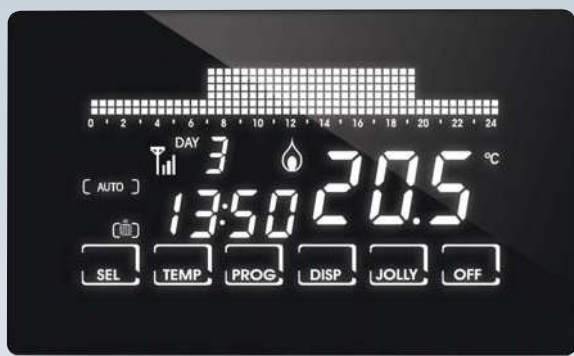

■ Intellitouch CH193WIFI



■ Intellitouch CH193BWIFI



- Heating and cooling systems management;
- Wireless connection: Wi-Fi 2.4 GHz;
- Weekly program;
- Operating mode: MAN manual, AUTO weekly programming, HOLIDAY daily programming, JOLLY temporary programming up to 90 days, OFF system switched off or with anti-freeze program;
- Screen lock password and screen cleaning lock;
- 6 touch keys, whose functions vary according to the operating environment;
- Acoustic signals: "buzzer" when keys are pressed;
- Perpetual clock-calendar with backup battery in case of a power cut;
- Semi-flush mounting on a recessed box 3 modules, 503 type;
- Power supply 230V-50Hz;
- ErP Class IV; 2% (Reg. EU 811/2013 - 813/2013).

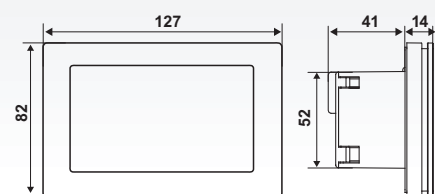

Semi-flush mounting
installation in 3-module 503
embedded boxes

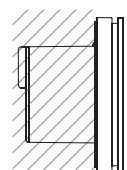

Intellicomfort CH180WiFi



Wall mounting weekly programmable thermostat with WiFi connection

White positive backlight LCD touch screen characterize the new wall mount programmable thermostat Intellicomfort CH180WiFi.

CH180WiFi is provided with 6 keys and their functions change according to the displayed description correspondent to each key.

Intellicomfort CH180WiFi has a weekly program to control heating and cooling systems, with WiFi connection for direct control or by Intelliclima+ APP on smartphones and tablets.





With Intelliclima+ and CH180WiFi you can control the home temperature from smartphone!



- Heating and cooling systems management;
- Wireless connection: Wi-Fi 2,4 GHz (802.11 b/g/n);
- Weekly program;
- Operating mode: MAN manual, AUTO weekly programming, HOLIDAY daily programming, JOLLY temporary programming up to 90 days, OFF system switched off or with anti-freeze program;
- Adjustable differential 0.3 ÷ 5 K;
- Screen lock password and screen cleaning lock;
- 6 touch keys, whose functions vary according to the operating environment;
- Acoustic signals: "buzzer" when keys are pressed;
- Perpetual clock-calendar with backup battery in case of a power cut;
- CH180WIFI has to be installed on the wall or in a
- 3 modules or round flush mounting box;
- Power supply 230V-50Hz;
- ErP Class IV; 2% (Reg. EU 811/2013 - 813/2013).

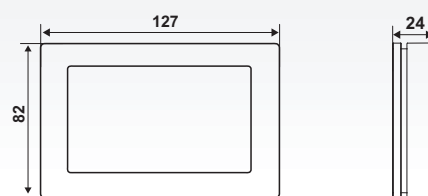

Wall mounting installation in 3-module 503 embedded boxes

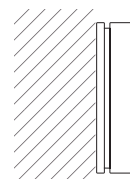

AN APP FOR YOUR COMFORT

Intelliclimate +



With the Intelliclimate+ APP you're always connected to your Fantini Cosmi CH193WiFi or CH180WiF programmable thermostats and you can manage your ideal comfort levels in a simple and intuitive way, from a smartphone or tablet, wherever you may be. With Intelliclimate+ you can:

- Switch the heating/cooling system on or off;
- Check the state of your system in real time;
- Choose your ideal temperature at any time and until when it set;
- Create your weekly or daily programme or choose from those preset;
- Optimise your comfort and save energy;
- Receive push notifications of generic alarms and anomalies in your system.

SIMPLE AND INTUITIVE GRAPHICS

The graphical interface is modern, extremely intuitive and allows you to easily control your IntelliTouch CH193WiFi.



CONTROL AND SHARE

The Intellilima+ APP lets you share your programmable thermostat control with any users of your choice.

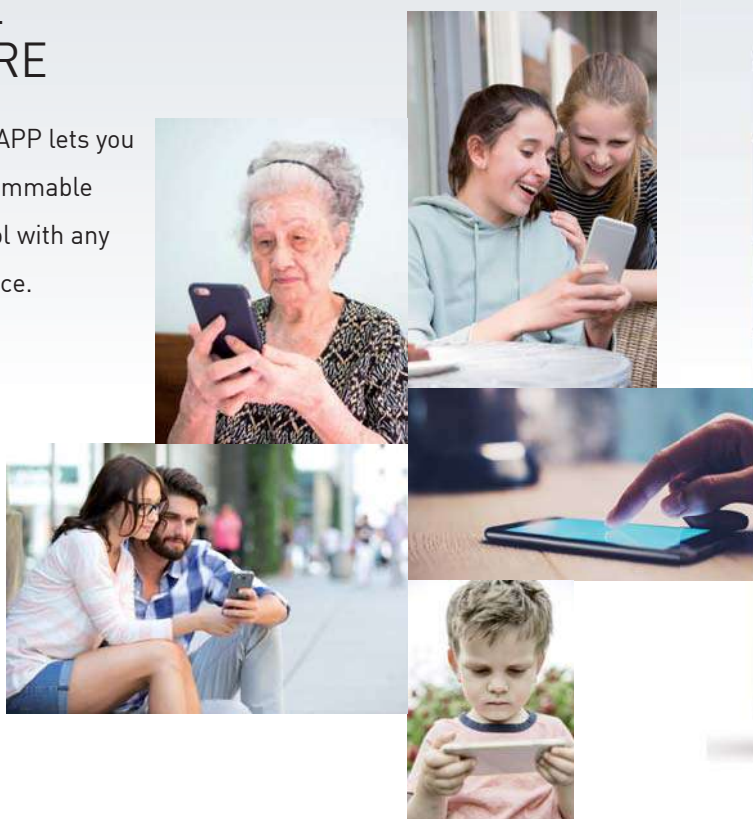

CHOOSE YOUR COMFORT

Use the Intellilima+ APP for all your CH193WiFi or CH180WiFi programmable thermostats: at home or in the office, beach side or mountain side.

Indeed, Intellilima+ can control several homes and several programmable thermostats within a single home.

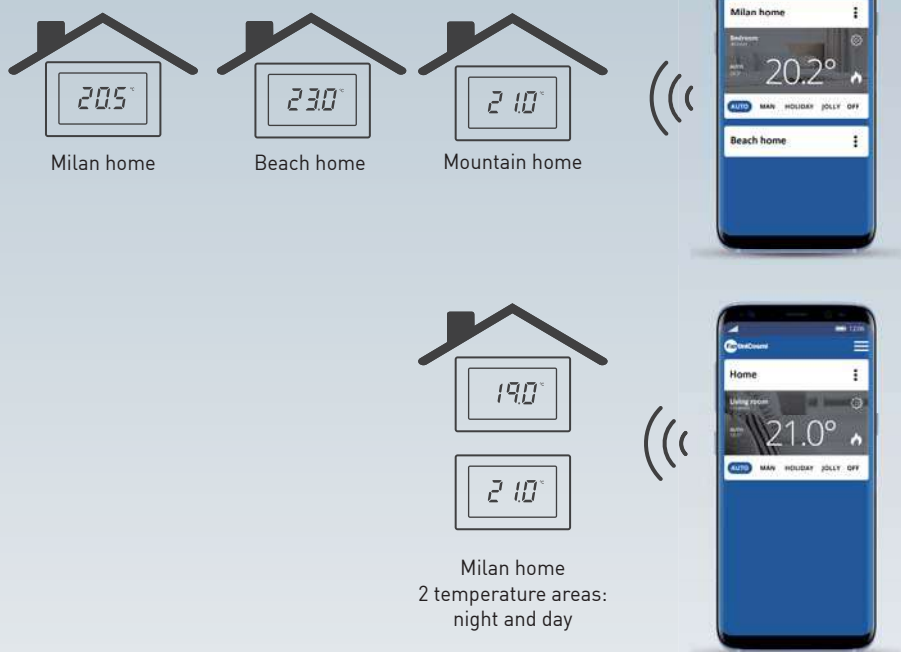

CUSTOMISE YOUR COMFORT

Customise your APP with your pictures, click and choose your favourite ones.

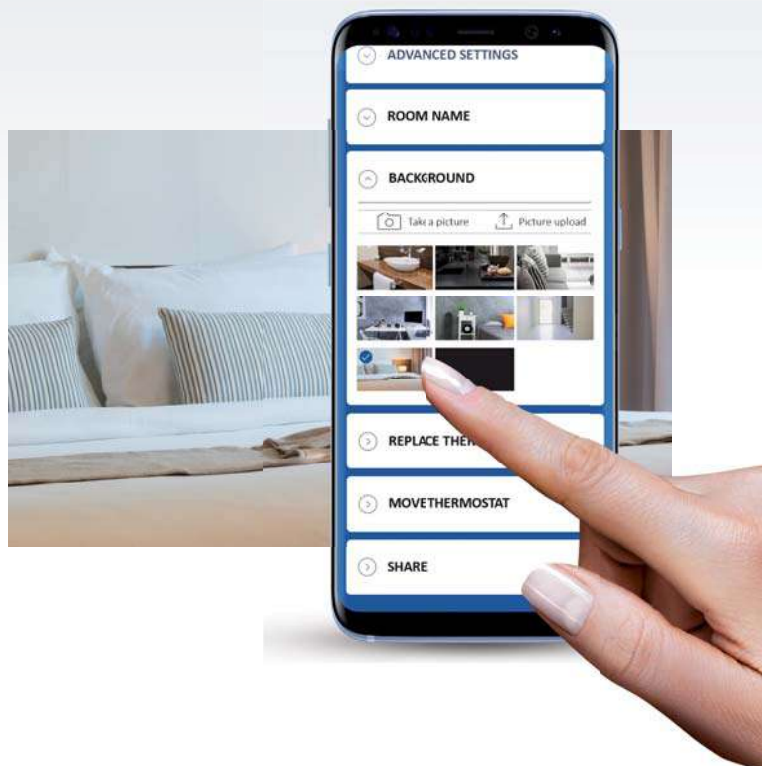

PRESET PROGRAMMES

Start using your programmable thermostat immediately with the programmes; Intelliclima+ provides you with useful preset programming profiles that will help you program and manage your comfort.

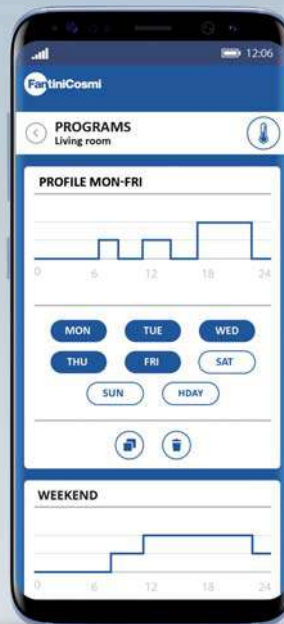

GUIDED INSTALLATION

You can use an installation wizard to configure the APP and your programmable thermostat in just a few simple steps.

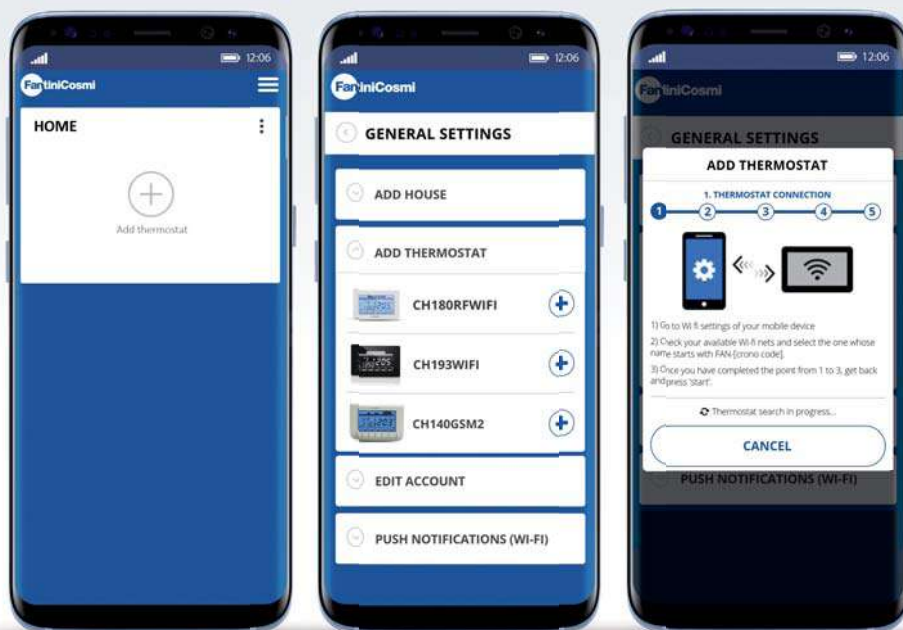

The Intelliclima+ APP is available for free on:





FANTINI COSMI SPA Via dell'Osio, 6 - 20090 Caleppio di Settala MI, Italy
Ph. +39 02 956821 | Fax +39 02 95307006 | info@fantinicosmi.it

EXPORT DEPARTMENT
Ph +39 02 95682229 | Fax +39 02 95307006 | export@fantinicosmi.it

www.fantinicosmi.com